

**PLASTIC RESERVOIR**

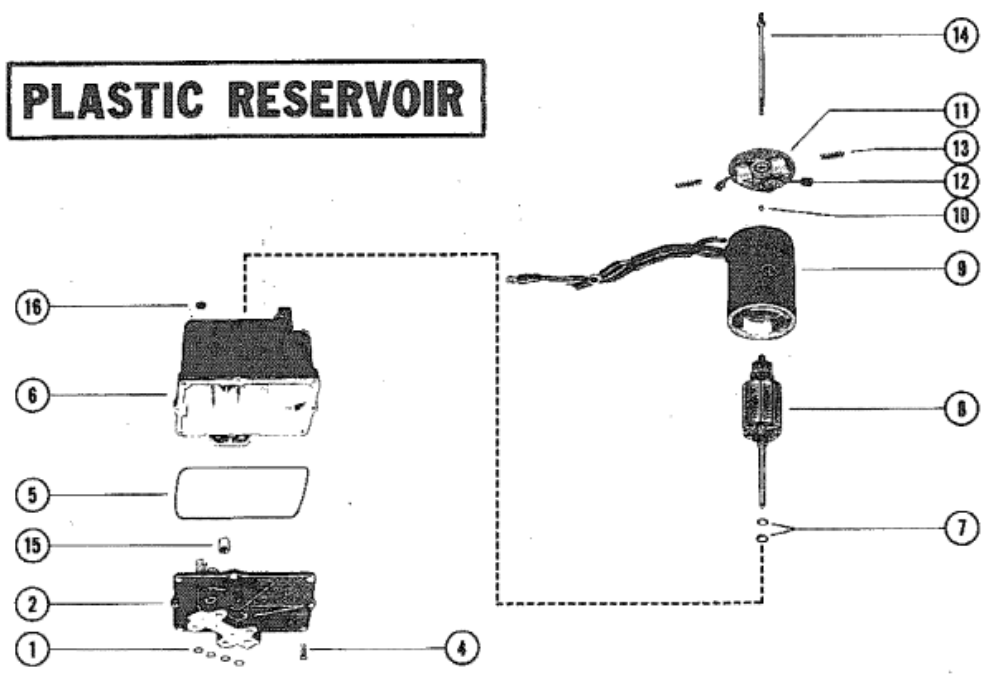

Parts List						
Ref	Class	Part	Description	Qty	Comment	Footnote
.		88475A	HYDRAULIC PUMP ASSEMBLY, C	1,		
.		93247A	HYDRAULIC PUMP ASSEMBLY, C	.1		
1	25	48171	"O" RING, HYDRAULIC PUMF	4,		
2	392	7734	VALVE BODY AND GEAR ASSE	1,		
2	392	8263	VALVE BODY AND GEAR ASSE	.1		
4	10	69570	SCREW, VALVE BODY TO RESI	8,8		
5	392	7735	SEAL, RESERVOIR TO VALVE E	1,1		
6	392	7731	RESERVOIR ASSEMBLY (PLAS	1,1		
7	392	7732	WASHER, THRUST-ARMATURE	AR,AR		
8	392	7729	ARMATURE, FIELD AND FRAM	1,1		
9	392	2942	FIELD AND FRAME ASSEMBLY	1,		
9	392	8261	FIELD AND FRAME ASSEMBLY	.1		
10	392	7730	BALL, COMMUTATOR END PLAT	1,1		
11	392	2940	PLATE ASSEMBLY, COMMUTA	1,		
11	392	8262	PLATE ASSEMBLY, COMMUTA	.1		
12	392	2941	BRUSH SET, COMMUTATOR	1,1		
13	393	2529	SPRING SET, BRUSH TENSION	1,1		
14	392	7733	BOLT SET, THRU-PLATE AND FI	1,1		
15	392	7727	COUPLER AND SAHFT	1,1		
16	392	7728	FILL PLUG, RESERVOIR	1,1		